



Alexander Marine International
18TH FLOOR - TWO CHINACHEM PLAZA
HONG KONG

OCEAN ALEXANDER®

UPGRADE/OPTIONS LIST

Ocean Alexander 32L Motor Yacht Hull No.32L11 (Model Year 2025)

| NO. | DESCRIPTION |
|------------|--|
| | One unit of Ocean Alexander 32L Motor Yacht with standard equipment |
| A. | EXTERIOR/INTERIOR DÉCOR OPTIONS |
| 1 | Skylounge in-lieu of standard flybridge |
| 2 | Electric shades with remote control for salon, dining, main deck electric doors, and staterooms |
| 3 | Dual electric helm seats in lieu of single manual |
| 4 | Full height electric glass sliding door in lieu of manual sliding door at salon (aft), salon (port), salon (starboard) & skylounge (aft) |
| 5 | In-glass portlight for VIP and guest staterooms (4x) |
| 6 | Port and starboard staterooms side-by-side berths can slide together and convert to single queen berth |
| 7 | TOTO toilet (1x for master) |
| 8 | Heated stone floor in master bathroom |
| B. | MAJOR MECHANICAL/ELECTRICAL EQUIPMENT |
| 1 | Stabilizers & thrusters package |
| 2 | Mechanical/electrical convenience package |
| 3 | Headhunter sewage treatment system (600Gal/day) |
| 4 | Entertainment system |
| 5 | Extended cruise package |
| 6 | Add plug-in engine wired remote at aft deck and bridge deck |
| 7 | Spare parts package |
| 8 | Water maker and purification package (1200Gal/Day) |

| C. | EXTERIOR OPTIONS |
|----|---|
| 1 | 3-person jacuzzi w/ dedicated 17KW tankless water heater, on bridge deck with sunpad on port and starboard side |
| 2 | Teak decking package |
| 3 | Exterior awning/protection package |
| 4 | Exterior convenience package |
| 5 | Hydraulic 2,000 lbs. capacity hi-low swim platform with integrated ladder. |
| 6 | Aft-deck transom structural reinforcement per Froude Friction Evaluation for towing tender based on towing force for an approximate 45 ft (13.7 m) Length/ 13 ft (3.66 m) beam, 25,000 lbs. (11,340 kg) displacement boat, with capstans (tender not included). |
| 7 | Aft-deck custom ceiling feature with indirect lighting |

32L11 MOTOR YACHT

2025 Model Year



OCEAN ALEXANDER®

www.oceanalexander.com

Ocean Alexander reserves the right to make modifications and improvements which may result in differences from published specification.

32L11 MOTOR YACHT

PARTICULARS:

| | | |
|---|----------------------------------|--------------|
| Length overall | 32.5 m | 106' 7" |
| Waterline length | 27.1 m | 88' 10" |
| Beam overall | 7.10 m | 23' 2" |
| Tonnage | 210 GT | |
| Draft at full load | 1.81 m | 5' 11" |
| Daft at half load | 1.75 m | 5' 9" |
| Height above waterline (half load, antennas excluded) | 10.10 m | 33' 2" |
| Full Load displacement (approximately) | 119,800 kg | 264,114 lbs. |
| Half Load displacemeny(approximately) | 112,300 kg | 247,579 lbs. |
| Fuel capacity | 15,141 L | 4,000 gal. |
| Fresh water capacity | 2,460 L | 650 gal. |
| Black water capacity | 1,514 L | 400 gal. |
| Speed and range | Refer to performance data | |
| Standard Generator | Twin Kohler® 40 KW | |
| Standard Power | Twin MAN® V12 2000 HP | |
| Exterior Paint | Off White Alexseal® polyurethane | |
| Interior décor scheme | Novus Dusk | |

Specifications and equipment are subject to change without notification and dimensions are best approximate

Top speed and cruise range are from 32L11 sea trial data under certain condition. Actual performance depends on different sea and boat conditions and options selected by customer, Ocean Alexander does not guarantee.

General Arrangement may show optional equipment.

CONSTRUCTION:

General:

- The Yacht is constructed in high-density closed-cell structural foam. High density foam allows for high temperature and advantages in thermal and acoustic insulation.
- Longitudinal and lateral fiberglass foam-core stringers.
- Fiberglass with Vinyl Ester/Epoxy infusion lamination manufacturing technology, increases strength by 20% and reduces weight by 18% compared to hand-layup.
- Reinforced collision bulkhead.
- Cross-knit carbon fiber in high stress areas to increase structural integrity and torsional strength.
- Water-tight bulkheads with sound and temperature insulation.
- Ocean Alexander employs various techniques to reduce sound and vibration. Some of these techniques include multiple insulation barriers including reflective materials, absorptive materials, dampening materials, air pockets and flexible isolation mounts for controlling sound and noise transmission.
- Painted exterior surfaces with professional grade epoxy-based primers and Alexseal polyurethane paint resulting in the highest gloss retention compared with gelcoat or other paint brands. Guarantee color match by Alexseal®.
- All exterior hardware to be 316 stainless-steel or per manufacturer requirements.
- Aluminum components meet marine grade 5052 or 6061 specification.
- Engine foundation: Main engine stringer will be constructed from stainless-steel plates custom formed to encapsulate over engine structural stringers. Allows for industry leading support and isolation.
- Frameless windows.
- Exterior ceiling panels removable for easy service of navigational electronics and plumbing runs.
- OA uses CPVC instead of PVC in both potable water system and chiller A/C system. CPVC can handle temperature up to 200°F (93°C), while PVC peaks at 140° (60°C). Reducing risk of joints and pipes failing, and therefore, failure of the plumbing system. CPVC piping is also extremely resistant to corrosive chemicals. CPVC can handle salts, caustics, and acids better than metal and other thermoplastics. There is no pH limitation either, which means that it can hold up to large pH swings with no damage.
- Sound insulation above bilge mechanical areas with rubber for motors.
- Lightning protection system. Lightning arrestor pole installed on mast with dedicated ground cable to grounding plate attached to underwater hull surface. Minimizes potential lightning strike damage to yacht electrical and critical systems.

Hull / Bottom:

- Interior structural components all bonded to hull.
- Three coats of "self-polishing" antifouling bottom paint shall be applied on three coats of anti-blister epoxy barrier coats.
- FRP rub rail w/ 316 stainless-steel striking plate.
- Bronze through-hull fittings.

MECHANICAL:

Main Engines:

- MAN® V12 2000 HP engine "MAN Gold Standard" includes: 60-month warranty on main components: crankcase, crankshaft, connection rods, flywheel.
- Add plug-in engine wired remote at aft deck and bridge deck.
- Stainless-steel engine beds and stainless-steel removable rails on side of engines.

- Delta-T® intake/exhaust fans with variable frequency drives shall be mounted to facilitate the intake and/or exhaust of air through the machinery spaces and providing a high air exchange rate. Air intake & exhaust ducts shall have fire dampers installed with manual and automatic triggering that shall be tied into the machinery shut down circuits.
- Delta-T® moisture eliminators shall be installed at front of intake and exhaust ducts.
- Delta-T® fans for engine exhaust located on superstructure vs hull side. Maximizes water protection and salt spray intrusion into engine space, extending life of engine room components.
- Hard coating with Al6XN alloys on exhaust, provides higher corrosion resistance, especially in the forms of pitting, crevice, and stress cracking.
- Engine raw water-cooling using cupronickel 90/10 which offers superior corrosion resistance and inherent bio-antifouling.

Stabilizers & Thrusters Package:

- Sidepower Vector Fin 15 sq. ft. (1.4 sq. m.) hydraulic stabilizer fins with zero speed stabilization function.
- Sidepower patented "curved" fin design not only provides lift underway it is also unique in the industry with active "predictive" inertia control.
- Up to 50% more efficient than flat fins at anchor.
- Up to 30% more efficient than flat fins underway.
- 48.8HP for bow and 42.6HP for stern thrusters.

Shafting / Propellers / Steering:

- Ocean Alexander designs in oversized shafts, rudder and other drive train systems typically one-class larger than the competition. This results in superior handling and longevity in the Ocean Alexander drive-train system.
- High performance computer designed and machined Nibral propellers.
- Twin Disc® Hydraulic steering system.
- Stainless-steel rudders w/integrated zinc plates.
- Ocean Alexander 5-blade propellers to provide better holding power and handling.
- 22HS or similar high-grade austenitic alloy stainless steel propeller shaft that provides superior corrosion resistance along with excellent toughness and high strength
- Utilization of laser-assisted calibration instrument to ensure alignment of the drive shaft.

Windlass / Mooring:

- Dual (2) hydraulic vertical anchor windlasses w/ remote foot switches.
- Dual (2) 240 lbs. (108kg) high-holding power anchors. The anchor's chain consists of 250' (76.2m) on each side, made of 1/2" (12.5 mm), attached to the anchors with stainless-steel high-tensile swivels.
- Anchor chain wash system for freshwater cleaning of chain during anchor operation.
- Two 1500W, 24VDC motor capstans on aft deck, with control switches.

Air Conditioning:

- Dometic® chilled water system air conditioning system, rated for "Extreme Tropical Climates" (with reverse cycle heat for operation down to 40°F water temp).
- Refrigerant type is accepted worldwide under the Montreal Protocols.
- Dedicated engine room air conditioning.
- Ocean Alexander Clean Air System incorporates Nano-mesh UV sterilization technology to remove up to 99.9% of bacteria, fungi, mold, virus, fumes and odors. System has no moving parts, is completely silent and ozone free. Ensures fresher, cleaner, and healthier air onboard.

Mechanical/ Electrical Convenience Package:

- Oil change system for engines + generators w/approx. 45 gal. used oil tank.

- Gulfcoast™ fuel polishing system
- Compressed air in engine room, aft deck and boat deck.
- Francis searchlight and spreader lights for swim step and boat deck.
- 3 x 32" navigation touch screens on helm (upgrade from 3 x 24").
- Onboard intranet, driven by 4G SIM card capable Wi-Fi router. Allows outside 5G Internet card and/or internal intranet net connection via supplied iPad to Systems monitoring, and other onboard video/ audio apps.
- Dimmer package for interior and exterior main ceiling lights and salon, master, VIP with KNX programmable lighting.
- Dual city water inlet system.
- Sea water and compressed air supplying with 110V outlet at boat deck for inflatable slide or other water toys.

Other Notable Features:

- Heavy-duty commercial grade pantograph windshield wiper & washer with intermittent function.
- Buell™ heavy-duty, 3-trumpet horn.
- Fireboy® (or equivalent) engine room fire extinguisher system with engine-shutdown feature.
- Ocean Alexander proprietary "dry bilge ventilation system" with dedicated bilge exhaust to outside. This provides constant airflow to keep the bilges dry and mildew free.
- Dedicated stainless-steel work bench with vice, Snap-on tool chest, and storage.
- Headhunter sewage treatment system. 600 gal./day (2,271L./day).

PLUMBING:

Fresh Water System:

- 316 stainless-steel water tank with sight gauge.
- Headhunter™ fresh-water system.
- Freshwater wash down at bow, stern, and upper deck.
- Dockside water connections.
- Two 40-gallon (151 liter) hot water heater with high density insulation with dual high efficiency heating element that speeds heating by 50%.

Fuel System:

- Marine grade aluminum fuel tanks with sight gauges and high- & low-level alarms, welded and pressure test to ISO standard.
- Stainless-steel fuel piping system.

Water Maker and Purification Package:

- Dometic® 1,200G/Day water maker w/ auto fresh water flush operation and integrated Spot-Zero XZ premium filtration system for drinking, bathing and cleaning.
- 4-stage "Best in Class" fresh water filtration/sterilization.
 - Stage 1: City water is initially filtered for heavy metals/large particles and sediment.
 - Stage 2: Water maker and City water is filtered for biofilms and with Nano Silver dosing, biocidal properties are maintained even in water tank.
 - Stage 3: From water tank filtered through active carbon (smells and odors) and bacteria filter.
 - Stage 4: UV water sterilizer is used as a final line of defense against microbiological bacteria/virus.

ELECTRICAL:

AC/DC System:

- OctoPlex™ NEMA 2000 electrical safety/security control system. Based on aerospace technology for remote activation, control and status reporting of all AC and DC breakers. Monitors all power sources (AC and DC) for voltage, frequency and amperage abnormalities and provide visual and audio alerts. Includes enhanced circuit breaker functionality with no-load indication. Brown-out capabilities provides sensors for main doors, tank level, bilge and battery monitoring of current, voltage and temperature.
- This security/safety automatic monitoring and alert capabilities include using Apple iPad or Android for remote access to operate, view, and arm OctoPlex™ data and navigation system with remote notification accessibility.
- Shore power connections: Two CM-8 100Amps cable master with 110'(30.5m) cables with Iso-boost which manages voltage drops due to shore power by boosting output voltage. Thus keeping electrical system stable.
- Lightning protection.

Navigation Package:

- Garmin 8700 Series Black Box with (3) 32" touch screens.
- Garmin GRID remote input device installed on helm chair.
- Garmin 25KW Open Array Radar.
- Garmin Autopilot GHC.
- Garmin VHF and Card Reader.
- Garmin Blackbox depth sounder.
- Garmin AIS with NMEA GPS.
- Garmin Marine Camera (2 in engine room and 1 aft deck).
- KVH® TracVision® UHD7 satellite TV antenna.
- Ritchie Compass 5".
- iPad with built-in Garmin App for navigational information viewing via iPad.

Entertainment System:

- Apple TV multi-zone distribution experience system for salon, MSR, skylounge, aft deck, and boat deck.
- Includes the following equipment installed at factory:
 - Salon: Electric flip down LED 55" TV with A/V system and subwoofer and satellite receiver.
 - MSR: Electric flip down LED 50" TV with A/V system and satellite receiver.
 - Sky lounge: Electric flip down LED 50" TV with A/V system and subwoofer and satellite receiver.
 - VIP stateroom: 43" TV with satellite receiver.
 - Guest stateroom: On wall LED 32" TV with satellite receiver.
 - Crew: On wall 32" TV with satellite receiver
 - Bridge deck: Manual flip down 32" TV with speakers and satellite receiver.
 - Aft deck: Electric flip down 43" TV with speakers and satellite receiver.
 - Pre-wire for future installation of custom A/V system throughout using CAT6 wire runs for future use.

Extended Cruise Package:

- Install on yacht as back-up, 2nd A/C sea water pump and 2nd A/C circulation pump, 2nd freshwater pump, 2nd hot water pump, 2nd overboard discharge pump, 2nd macerator transfer pump, and additional water maker.
- Custom S/S potholder for cook-top for securing pots.
- Additional washer & dryer, freezer, beverage cooler in lower foyer.

Spare Parts Package:

- Includes spare: Bilge pump, LED light, engine/ generator filter, wiper blades, touch up paint, fuses, engine manufacturer spare parts kit, generator manufacturer spare parts kit, float switch, Vimar outlet, GFI outlet, Vimar switch.

ACCOMODATIONS / INTERIOR & EXTERIOR DETAILS:

Interior / Exterior:

- Windows with dramatic architectural details allowing for 28% greater visibility and incoming natural light.
- Hardtop with dedicated custom removable 316 stainless-steel ladder to top side of hardtop
- Elliptical 316 stainless-steel handrails & stanchions.
- 316 stainless-steel cleats.
- Two stainless-steel flagpoles, one each at bow and stern.
- Weather-tight door on side deck for access to crew area.
- Flush-mounted deck lights.
- Sun pads at bow and bridge deck.
- Stone-topped wet bar with sink, refrigerator, icemaker on bridge deck & aft deck.
- Elka® carbon fiber shower rod with flush connection at swim step.
- Electric shades with remote control for salon, dining, main deck electric doors, and staterooms.
- Full height electric glass sliding door in lieu of manual sliding door at salon (aft), salon (port), salon (starboard) & skylounge (aft).
- 3-person Jacuzzi w/ dedicated 17kw tankless water heater, on bridge deck with sunpad on port and starboard side.
- Hydraulic 2,000 lbs. capacity Hi-Low swim platform with integrated ladder.
- Aft-deck transom structural reinforcement per Froude Friction Evaluation for towing tender based on towing force for an approximate 45 ft. (13.7 m) Length/ 13 ft. (3.66 m) beam, 25,000 lbs. (11,340 kg) displacement boat, with capstans (tender not included).
- Aft-deck custom ceiling feature with indirect lighting.

Teak Decking Package:

- Aft deck to bow side deck.
- Steps from aft deck to bridge deck.
- Steps from swimdeck to aft deck.
- Swimdeck.
- Bridge deck.

Exterior Awning/Protection Package:

- Sun awning for boat deck, swim step and bow with custom-made carbon poles and marine-grade exterior Ferrari mesh fabric. Includes custom designed built-in storage for poles.
- Custom exterior protection canvas covers for exterior cabinetry and windshield mesh cover.
- 316 Stainless-steel transom gates for pet/child protection.
- Boat deck hatch.

Exterior Convenience Package:

- Custom-designed exterior factory built settee package with hi-low electric coffee table at boat deck.
- Boarding ladder installed at recessed starboard gunnel with teak.
- Bow concealed "pop-up" lights (4x)
- 32" Electric-Chef barbecue at bridge deck
- High output LED underwater lights covering stern x4, port side x2 and starboard side x2, each designed to wrap around transom with light.

- Exterior bar stools x3

Salon:

- Custom-designed furniture and sofa.
- Custom-designed window mullion with ceiling treatment.
- Custom-designed salon table

Dining Room:

- Room divider cabinet fitted out for storage
- Adjustable shelf tracks and dividers installed for china, glass, and silver storage.
- Ten-person dining table secured with chairs.
- Day head with sink and open shelf cabinet.

Galley:

- Lacquered cabinetry with positive-latch doors.
- Galley storage cabinetry with hidden hinges.
- Cambria® stone countertop.
- Blanco® stainless-steel kitchen sink.
- Overhead dish locker fwd. & stbd.
- Wolf® 36" electric cook top.
- Wolf® 30" electric oven.
- VIKING® 30" microwave.
- Sub-Zero® 36" refrigerator.
- Sub-Zero® 30" wine cooler.
- ASKO® 30" dishwasher
- Whirlpool™ garbage disposal.
- Whirlpool™ trash compactor.
- Scotsman Brilliance® gourmet clear ice maker.

Skylounge:

- Skylounge in-lieu of standard flybridge.
- Custom-designed furniture and sofa.
- Day head
- Refrigerator/ ice maker under counter.
- Wood and padded leather control console
- Ship's alarm panel for bilge and tank monitoring.
- Red light for nighttime running.
- Navigation area/ship's office with file drawers.
- Forward windows with four windshield wipers with freshwater nozzles.
- Radio desk & chair.
- Storage locker.
- Dual electric helm seats in lieu of single manual.

Master Stateroom:

- King-sized berth with innerspring mattress and storage beneath.
- Two nightstands with stone countertops.
- Vanity table.
- Day head with sink.
- Walk-in closet with built-in bureau forward of ensuite, includes hidden safe for valuables.
- Custom large shower, fitted with tempered glass enclosure with securing device, door will be stainless-steel hinge.

- Absorption mini fridge.
- TOTO® toilet (1x for master). With auto flush, lid closing, heated seat adjustable spray and 3-mode washlet air purifying system with remote control.
- Heated stone floors in master bathroom.

VIP Staterooms:

- Queen-size berth with innerspring mattress and storage beneath.
- Headboard finished in upholstered fabric per interior designer's spec.
- Nightstands with drawers.
- Dressing mirror.
- Vanity/dressing table.
- Hanging locker with lighting.
- Privacy locksets.
- In-glass portlight for VIP staterooms.
- Head flooring selected stone.
- Shower fitted with tempered glass enclosure with securing device.

Guest Staterooms:

- Twin-size berth with innerspring mattress and storage beneath.
- Headboard finished in upholstered fabric per interior designer's spec.
- Nightstand with drawers.
- Hanging locker with lighting.
- Privacy locksets.
- Port and starboard staterooms side-by-side berths can slide together and convert to single queen berth.
- In-glass portlight for guest staterooms.
- Head flooring selected stone.
- Shower fitted with tempered glass enclosure with securing device.

Heads:

- Custom-made seamless fiberglass stall shower w/ one-piece glass door. Reduce mildew by providing a clean, easily disinfecting wipe-down surface.
- Air extraction in each head by low noise extraction fans.
- Tecma™ Marine toilet system throughout.
- Stone countertops and back splash in heads with china sink.

Crew Quarters:

- Kitchenette (sink, microwave, and refrigerator).
- Storage locker in each crew stateroom.
- Settee with table and storage beneath seating.
- Three crew staterooms: captain and two high-low bunk staterooms.
- N2KView linked Apple iPad for systems diagnostics/alerts/ settings in captain quarters.
- Dedicated stainless-steel work bench with vice, Snap-on tool chest, and storage.
- Washer & dryer.
- Crew quarters with private head and shower.

Turn Key:

- Safety first aid kit.
- Fenders, lines, flare kit, throw ring, fire extinguishers, and bell.
- Wheel puller for ship propellers.
- 1 x 16-person life raft.

- Bed linens for master (king 2x), VIP (queen 4x), guest (single 8x) with pillows cases.
- Bath robe and bath towel set (bath towel/hand towel/wash cloth) - 2 sets per stateroom.
- Dinner china including dinner/salad/dessert plates, soup bowls, teacup and saucers, casserole dish, salt & pepper shakers.
- Flatware including steak knife, dinner knife, fork, spoon and dessert/teaspoon, salad forks, serving spoons & fork.
- Water/white/red/champagne wine glasses.
- Toaster, electric mixer, measuring cup, rubber/ metal/ plastic spatulas, mixing bowls, chef knives, cutting boards, coffee machine and iron.

VESSEL SUPPORT (Unique OA Standard feature):

- Orientation: Prior to delivery. Owner and captain is provided with dockside orientation on the operation of vessel systems by Ocean Alexander personnel.
- Customer Support: OA customer support is on-call 24/7 to owner and crew.
- Vessel is provided with a complete owner's plan package including:
 - Docking Plan
 - Electrical schematic
 - Equipment information packages (User manual, warranty card...etc.)
 - Plumbing Plan
 - Outboard Profile
 - Fuel oil system diagram
 - Freshwater and drain diagram
 - Wastewater system diagram
 - Air-conditioning arrangement
 - Owner's Manual
 - Drawing Files Required for Application of Tonnage Certificate by Owner
 - Software & Wi-Fi set up info
 - Escape Route



ALEXANDER MARINE CO., LTD LIMITED WARRANTY

Alexander Marine Co., Ltd., (hereafter: "AMC") warrants to the original retail purchaser (meaning: the first purchaser/user of the vessel from time of delivery of the vessel in its new condition from AMC's factory) of an Ocean Alexander yacht that it will repair or remove and replace, or cause such to be done, at a place and in a manner in its sole discretion, any part which was both made and installed by it in the new vessel which is determined to be defective and which has been brought to its attention in writing within ONE YEAR of the first retail purchaser taking possession of the vessel. In cases of osmosis, structural issues, integral portion of the hull, deck, stringers, grid system and superstructure which is determined to be structurally defective, AMC must be notified within thirty days of discovery of such condition in order to allow for its repair and arresting of progress of the condition. Failure to so notify AMC shall automatically invalidate and extinguish this warranty as to such condition. Use of the vessel for commercial, business, or rental/charter purposes, misuse of the vessel and/or its components and systems, external damage from foreign objects, or use of the vessel in hazardous circumstances or extreme conditions (whether weather, water or failure to maintain and/or service as required by the manufacturer of the vessel or its components or systems) shall automatically invalidate and extinguish all warranties, whether express, implied or by operation of law. Alterations to the exterior finish, including but not limited to painted surfaces if altered, abused, damaged by foreign objects or chemicals or work by others on it, subjected to abnormal use or conditions (including but not limited to the aforementioned prohibition against commercial and business, rental or charter use), or has not been properly waxed and polished and maintained by the purchaser, or having being re-painted, addition of color stripes; shall also automatically invalidate and extinguish all warranties, whether express, implied or by operation of law.

WARRANTY EXCEPTIONS: What This Limited Warranty **DOES NOT COVER:**

1. Any boat that has been altered or modified from manufacturer factory specifications.
2. Any boat that has been salvaged or declared a total loss or a construction loss for any reason not covered by this Limited Warranty.
3. Engines, transmissions, windshield breakage, controls, propellers, batteries, appliances, other equipment, accessories, or components not manufactured by manufacturer, or which carry their own individual warranties.
4. Gelcoats, paints, varnishes, or other finishes (including cracking, crazing or discoloration), fabrics, canvas, anti-fouling bottom paint, stainless-steel, or any plated surfaces except as noted above.
5. Damage caused by misuse, electrolysis, galvanic corrosion, lack of proper maintenance, or improper trailering or any deterioration of underwater equipment.
6. Damage, tearing, fading, shrinkage or deterioration of carpet, upholstery, exterior canvas tops, enclosures or other soft goods.
7. Any Damage caused by accident, fire, or resulting from modifications, racing, abuse, commercial use, or negligence of boat owner, and loading the boat in excess of maximum limits on the capacity.
8. Damage from failure to perform routine periodic maintenance to the boat according to Manufacturer recommendations and any adjustments, realignment or replacement of normal wear items.
9. Incidental damages, including without limitation, transportation, haul out, loading, other expenses incurred in returning the boat for warranty service, loss of use, loss of time, inconvenience, mechanic's expenses or other incidental charges, such as lodging, phone calls, towing, rentals, fuel expense, or food.
10. Any representation or implication of speed, range, fuel consumption or estimated performance characteristics.
11. Any failure or defect arising from a repair made by a non-authorized provider, unless pre-approved by Manufacturer.
12. Any failure or defect caused by an act of nature resulting in damage, cost, or expense.
13. Any item exceeding the expressed coverage limits specified in this this Limited Warranty.
14. Manufacturer reserves the right to change or improve the design or manufacture of boats without any obligation to modify previous boats.
15. Any damage and/or scratches on glass, acrylic, plexiglass and/or any aforementioned surfaces due to improper cleaning and maintenance.

This warranty is in lieu of any other warranty implied or expressed. Manufacturer accepts no responsibility for any representations, acts, or omissions of its dealer relating to the preparation and/or sale of manufacturer boat products to original consumer. This warranty is transferable, and to do so the original owner or purchaser must register new ownership with Manufacturer Warranty Department.

ALL COSTS TO TRANSPORT THE BOAT FOR REPAIRS ARE THE RESPONSIBILITY OF THE OWNER.

SOLE REMEDY: THE REMEDY OF REPAIR OR REPLACEMENT OF PARTS OR MATERIALS THAT ARE FOUND TO BE DEFECTIVE IN FACTORY MATERIALS OR WORKMANSHIP COVERED BY THIS LIMITED WARRANTY SHALL CONSTITUTE THE OWNER'S SOLE AND EXCLUSIVE REMEDY AGAINST MANUFACTURER FOR ANY CLAIMS WHATSOEVER OF ECONOMIC LOSS RESULTING FROM PRODUCT FAILURE. In keeping with environmental policies and practices, Manufacturer reserves the right to utilize reconditioned, refurbished, repaired, or remanufactured products or parts in the warranty repair or replacement process. Such products and parts will be comparable in function and performance to an original product or part and warranted for the remainder of the original warranty period. In no event shall any repair or replacement under this Limited Warranty exceed the fair market value of the product as of the date of the owner's claim. Acceptance of any product returned, or any refund provided by Manufacturer shall not be deemed an admission that the product is defective.

OTHER LIMITATIONS: EXCEPT AS SET FORTH HEREIN, THERE ARE NO OTHER WARRANTIES EITHER EXPRESS OR IMPLIED PROVIDED BY MANUFACTURER ON THIS BOAT. ALL OTHER WARRANTIES, EXPRESS OR IMPLIED, INCLUDING IMPLIED WARRANTIES OF FITNESS AND MERCHANTABILITY, ARE EXPRESSLY EXCLUDED. MANUFACTURER FURTHER DISCLAIMS ANY LIABILITY FOR ECONOMIC LOSS ARISING FROM CLAIMS OF PRODUCT FAILURE, NEGLIGENCE, DEFECTIVE DESIGN, MANUFACTURING DEFECT, FAILURE TO WARN AND/OR INSTRUCT, LACK OF SEAWORTHINESS, AND ANY OTHER THEORY OF LIABILITY NOT EXPRESSLY COVERED UNDER THE TERMS OF THIS LIMITED WARRANTY. ANY IMPLIED WARRANTY OF MERCHANTABILITY OR FITNESS FOR A PARTICULAR PURPOSE IS DISCLAIMED. TO THE EXTENT THE IMPLIED WARRANTY CANNOT BE DISCLAIMED, IT IS LIMITED TO THE SHORTER OF ONE YEAR FROM THE DATE OF DELIVERY TO THE FIRST RETAIL OWNER OR THE DURATION OF THE RESPECTIVE EXPRESS LIMITED WARRANTIES STATED HEREIN. TO THE EXTENT ALLOWED BY LAW, NEITHER MANUFACTURER, NOR THE SELLING DEALER, SHALL HAVE ANY RESPONSIBILITY FOR LOSS OF THE BOAT, LOSS OF TIME, INCONVENIENCE, COMMERCIAL LOSS OR CONSEQUENTIAL DAMAGES. SOME STATES DO NOT ALLOW LIMITATIONS ON HOW LONG AN IMPLIED WARRANTY LASTS, SO THE ABOVE LIMITATION MAY NOT BE APPLICABLE. SOME STATES DO NOT ALLOW THE EXCLUSION OR LIMITATION OF INCIDENTAL OR CONSEQUENTIAL DAMAGES, SO THE ABOVE LIMITATIONS OR EXCLUSIONS MAY NOT BE APPLICABLE. THIS WARRANTY GIVES THE OWNER SPECIFIC LEGAL RIGHTS, AND THE OWNER MAY ALSO HAVE OTHER RIGHTS WHICH VARY FROM STATE TO STATE OR COUNTRY TO COUNTRY.

OWNER'S OBLIGATIONS: To initiate a warranty claim, it is the responsibility of the purchaser to contact an authorized dealer immediately after discovery of any defect, describe the nature of the problem, and provide a hull serial number, date of purchase, and name of selling dealer. The authorized dealer will notify Manufacturer, who is solely responsible for determining and authorizing in writing the remedial action(s) to be performed at either an authorized dealership chosen by Manufacturer or at the Manufacturer factory.

REGISTRATION & WARRANTY TRANSFER POLICY: Manufacturer provides each new boat owner with a product registration form which should be filled out and sent to info@oceanalexander.com within 30 days of purchase. Please complete and return the product registration form within 30 days of purchase of your boat in order to facilitate processing of warranty claims and for manufacturer notifications.

32L11 General Arrangement - Profile & Bridge Deck

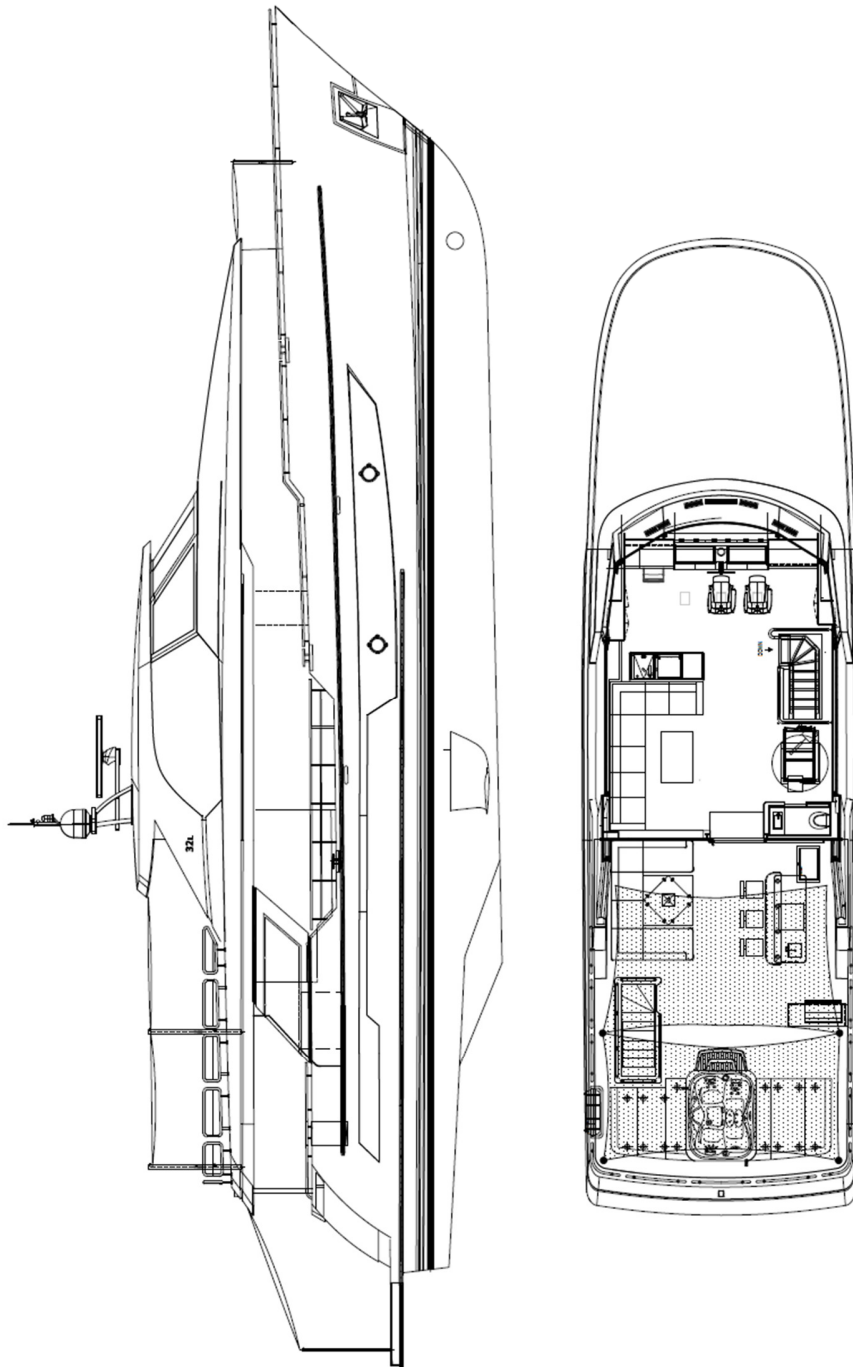

32L11 General Arrangement - Main & Lower Decks

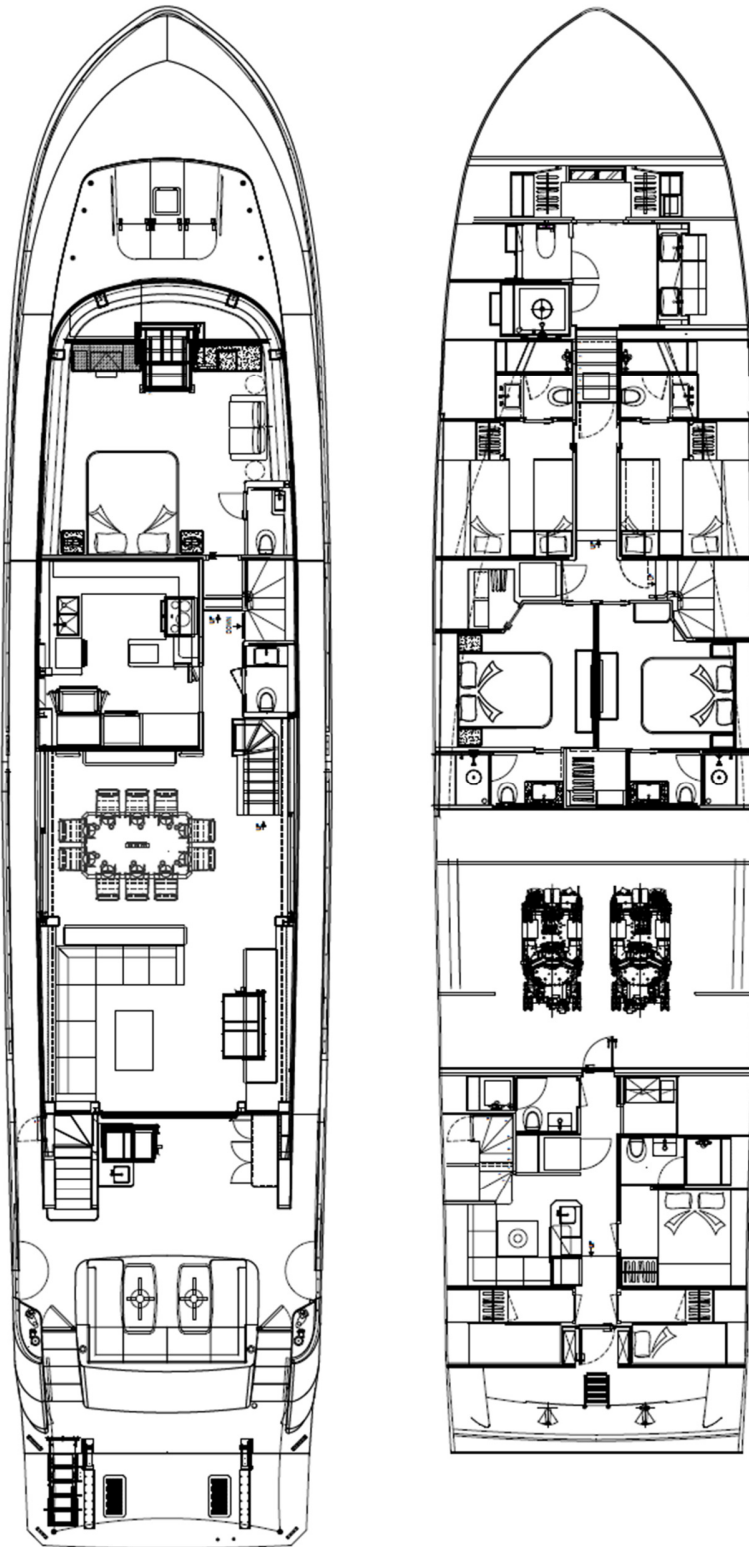

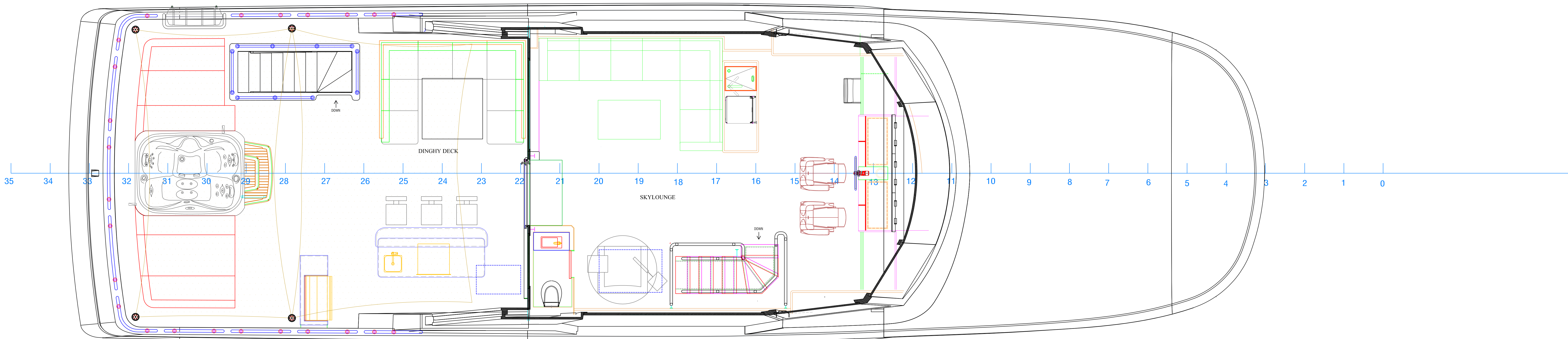
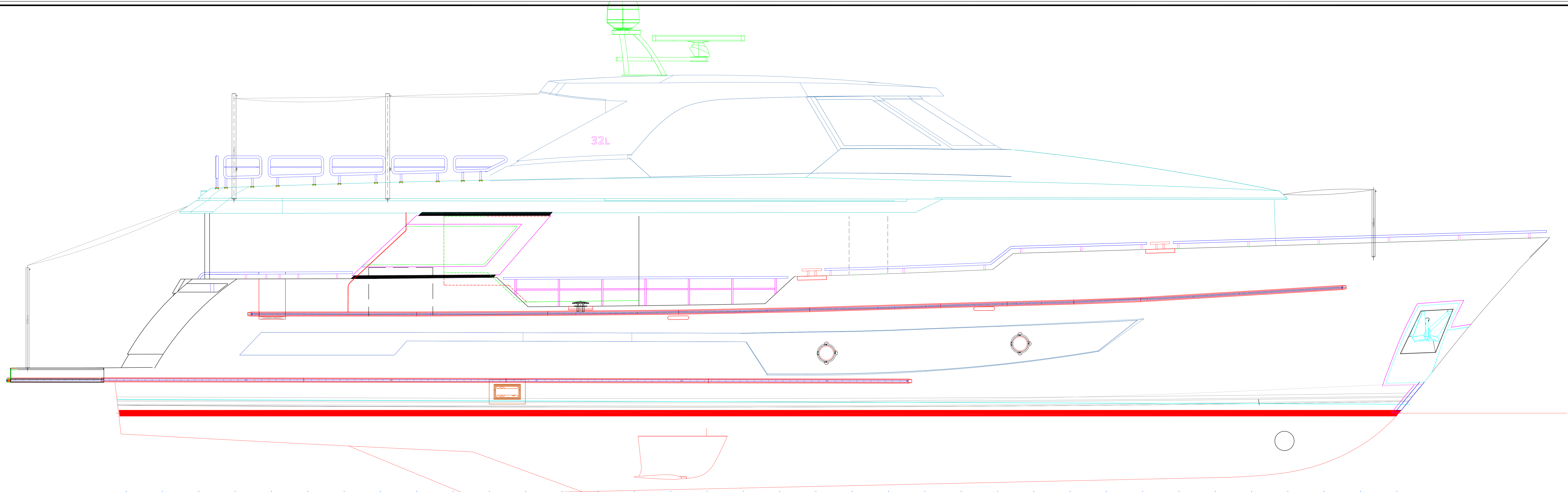

GENERAL NOTES

REFERENCES

MODEL:
OCEAN ALEXANDER
32L MOTORYACHT

Alexander Marine CO.,LTD
No.1, Jinfu Rd., Qianzhen District,
80668 Kaohsiung, Taiwan, R. O. C.
<http://www.oceanalexander.com>
email@oceanalexander.com

GA

| | |
|--------------|------------|
| DWN BY | Eric |
| VERIFY | JESSIE |
| SCALE | 1:30 |
| REQUEST DATE | ISSUE DATE |
| - | 29-FEB-23 |
| DWG. NO. | 32L11 XA01 |
| SHEET NO. | 1 of 2 |

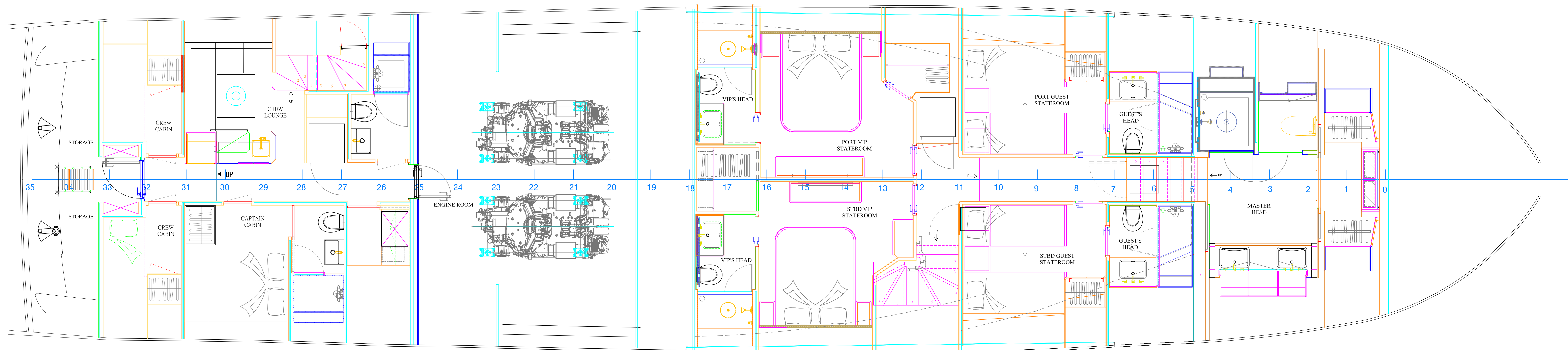
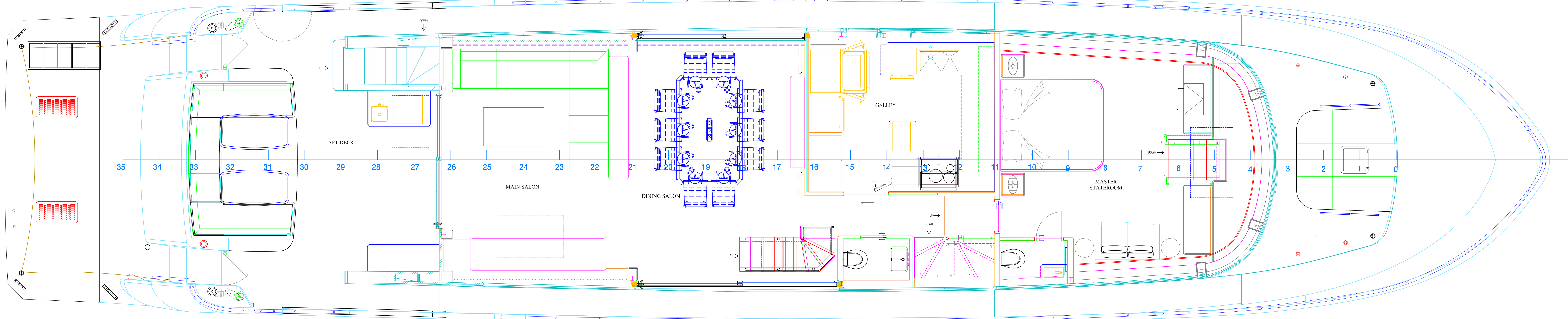

GENERAL NOTES

REFERENCES

MODEL:
OCEAN ALEXANDER
32L MOTORYACHT

Alexander Marine CO.,LTD
No.1, Jinfu Rd., Qianzhen District,
80668 Kaohsiung, Taiwan, R. O. C.
<http://www.oceanalexander.com>
email:taiwan@oceanalexander.com

GA

DWN BY: Eric
VERIFY: JESSIE
SCALE: 1:30
REQUEST DATE: -
ISSUE DATE: 29-FEB-23
DWG. NO.: 32L11 XA01
SHEET NO.: 2 of 2

Skylounge Sofa

Poltrona SC 31 Quarzo Fume



PH Desk Chair

Poltrona SC 34 Magesse

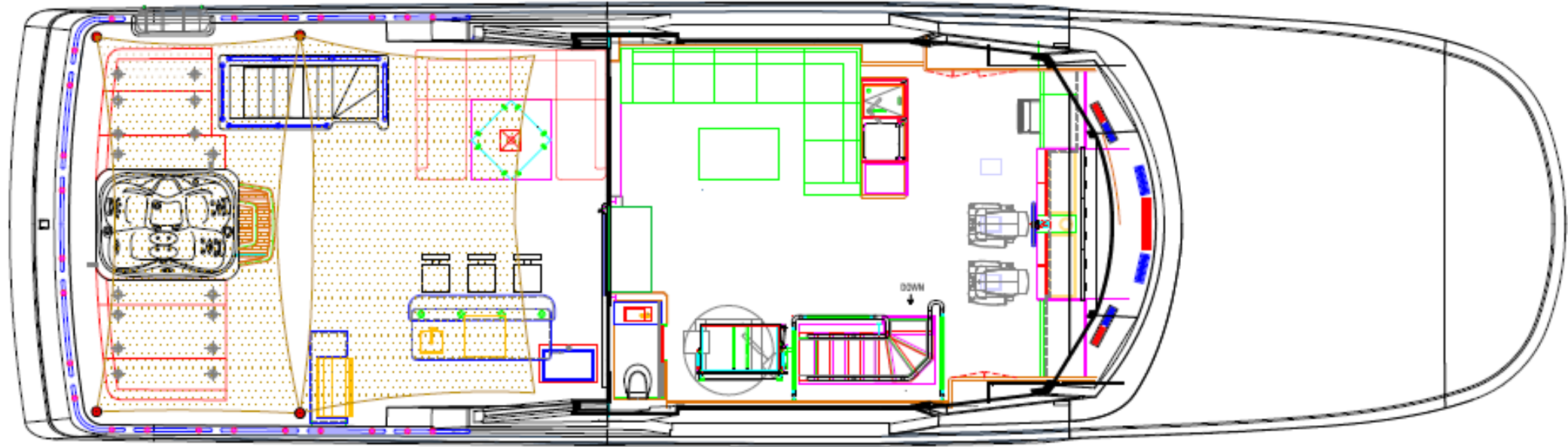

Extreior Seat Pads

Italvipla
SPRITE XL110



Extreior Bar Stool

Italvipla
SPRITE XL110



Walls

Majilite
JXDD4V-A65T2

Ceiling

Majilite
JX42B2V-T2

32L11 Bridge Deck
Fabric Layout-20230919
Scheme: Dark

Extreior Seat Pads

Italvipla
SPRITE XL110



Salon Sofa

Poltrona SC 31 Quarzo Fume



Dinning Chair

Poltrona SC 34 Maggese



MSR Armchair

Poltrona
External-Cammello GA-1 Saddle
Internal-Palto Bianco 01 135100



MSR Vanity Chair

Poltrona
SC 05 Stucco

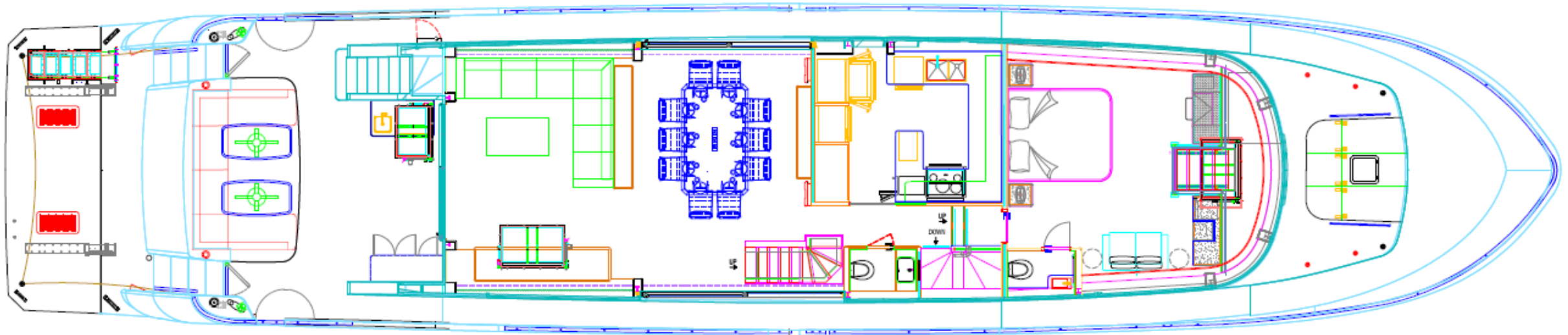

Walls

Majilite
JXDD4V-A65T2

Ceiling

Majilite
JX42B2V-T2

Salon Faux Blinds

Tackler
1957-01

MSR Faux Blinds

Rubelli
Vivienne Bianco 30300-001

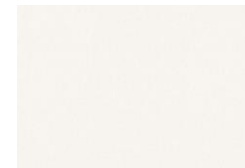

32L11 Main Deck
Fabric Layout-20230919
Scheme: Dark

Twin VIP Faux Blinds

Zimmer Rhode
10572-990

Twin Guest Faux Blinds

Zimmer Rhode
10572-990

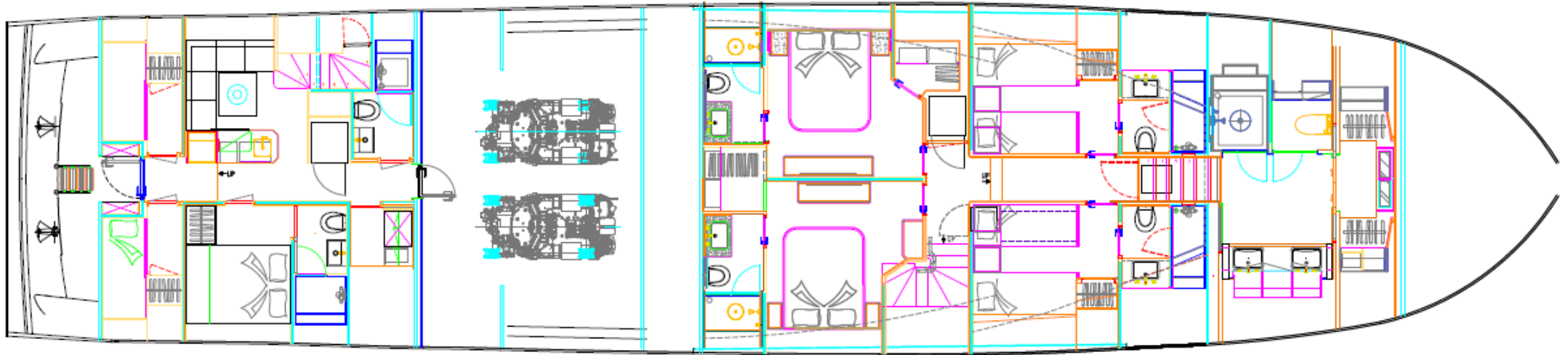

Walls

Majilite
JXDD4V-A65T2

Ceiling

Majilite
JX42B2V-T2

32L11 Lower Deck
Fabric Layout-20230919
Scheme: Dark



Cambria Delgatie



Cambria Whitby



Cambria Swanbridge

Delgatie
Entrance Floor

Whitby
Counter top

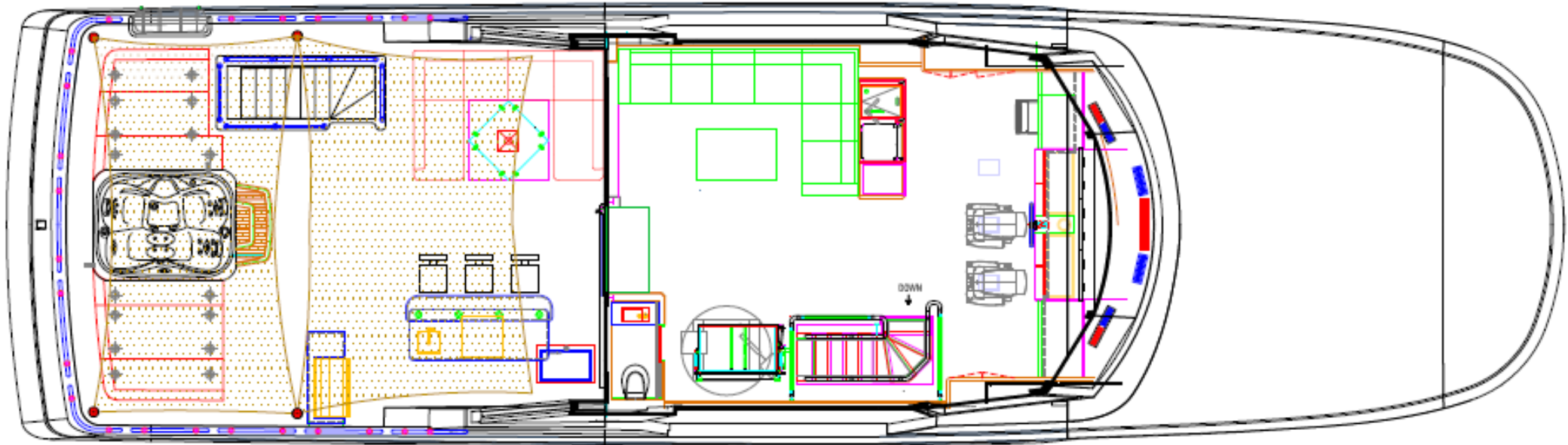

Swanbridge
Exterior Counter top

Whitby
Dayhead Countertop & Floor



Cambria Whitby



Cambria Highgate



Cambria Swanbridge

Aft Deck
Swanbridge
Countertop

Dining
Whitby
Countertop

Galley
Swanbridge
Countertop

Master Str
Whitby
Countertop & Nightstand

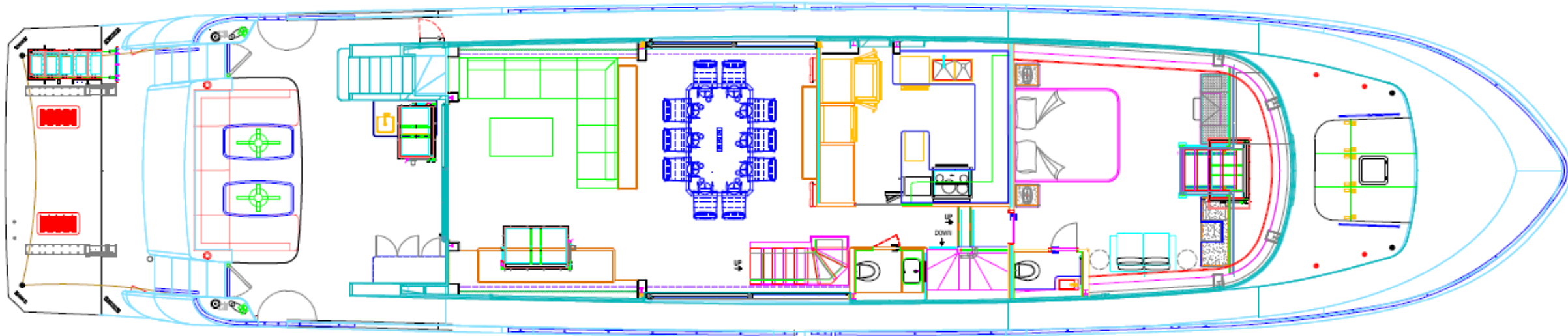

Salon
Whitby
Countertop

Salon Dayhead
Whitby
Countertop/Floor

Master Dayhead
Glabstone
Countertop/Floor

32L11 Main Deck
Stone Layout-20230919
Scheme: Dark



Cambria Delgatie



Cambria Newport



Cambria Gladstone

VIP
Newport
Nightstand & countertop

Guest
Newport
Nightstand

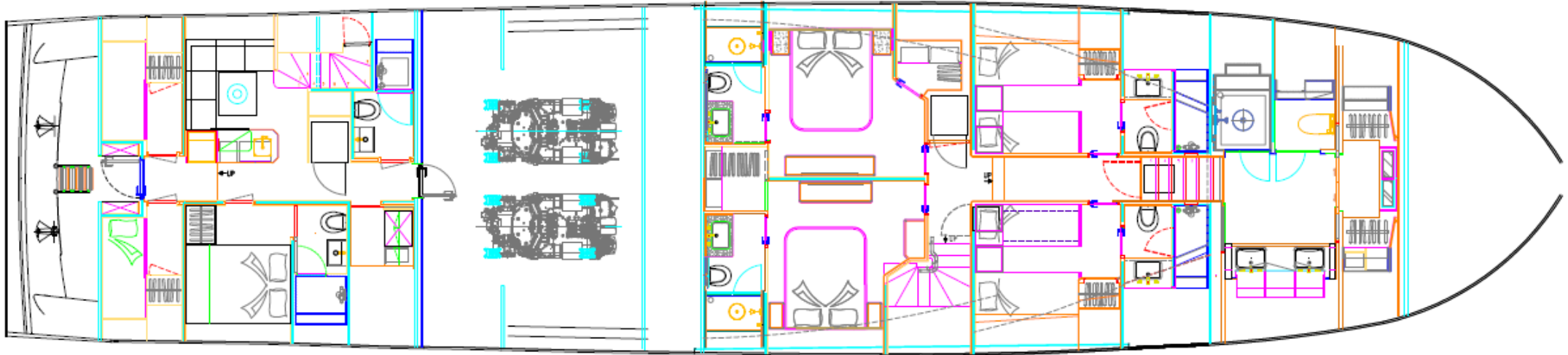

VIP Bathroom
Newport
Floor/Countertop

Guest Bathroom
Newport
Floor/Countertop

Foyer
Delgatie
Floor

Master Bathroom
Glabstone
Floor, Wall, Countertop & Splash back